

TYPICAL PLAN

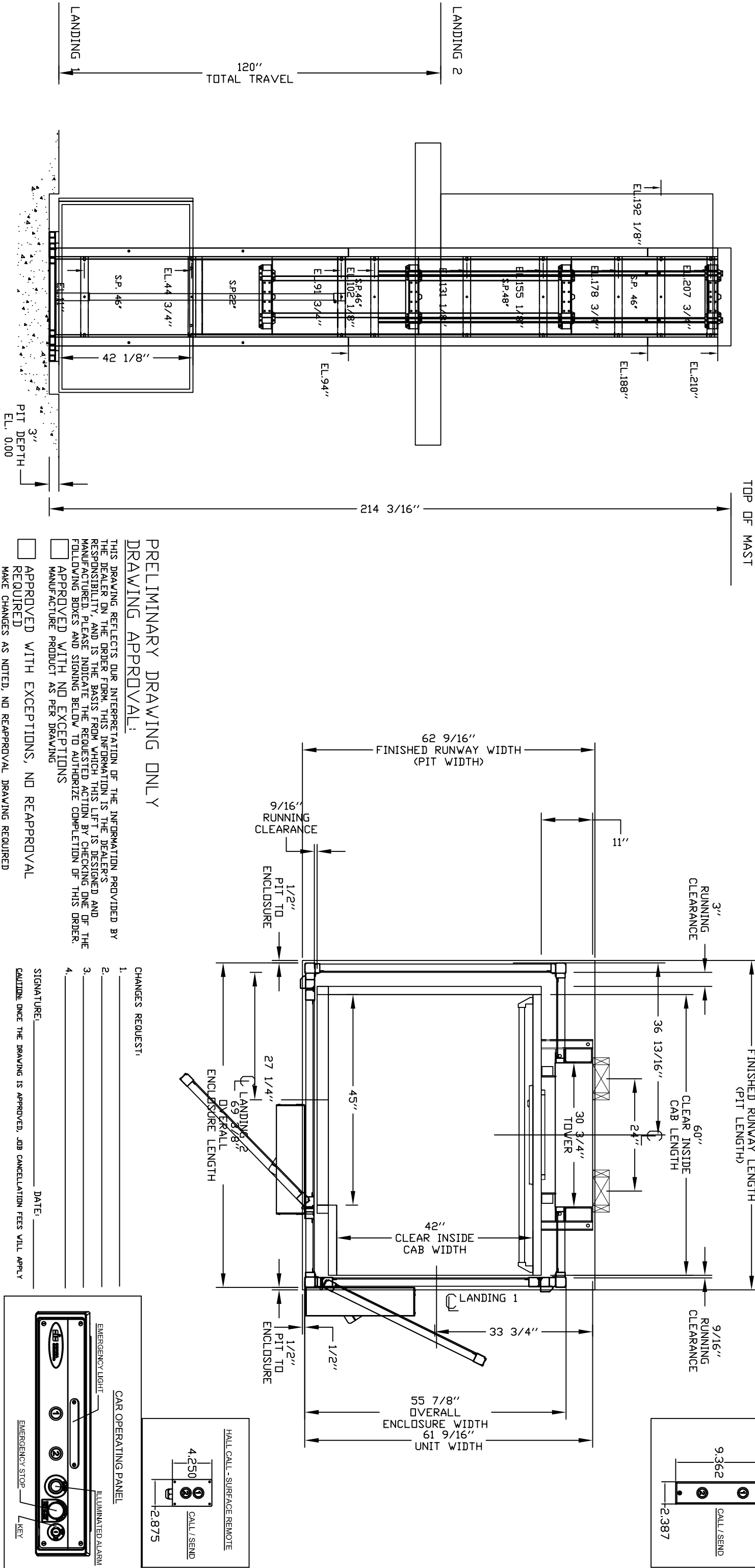

PRELIMINARY DRAWING ONLY  
DRAWING APPROVAL:

THIS DRAWING REFLECTS OUR INTERPRETATION OF THE INFORMATION PROVIDED BY THE DEALER ON THE ORDER FORM. THIS INFORMATION IS THE DEALER'S RESPONSIBILITY, AND IS THE BASIS FROM WHICH THIS LIFT IS DESIGNED AND MANUFACTURED. PLEASE INDICATE THE REQUESTED ACTION BY CHECKING ONE OF THE FOLLOWING BOXES AND SIGNING BELOW TO AUTHORIZE COMPLETION OF THIS ORDER:

- ☐ APPROVED WITH NO EXCEPTIONS  
MANUFACTURE PRODUCT AS PER DRAWING
- ☐ APPROVED WITH EXCEPTIONS, NO REAPPROVAL  
REQUIRED  
MAKE CHANGES AS NOTED, NO REAPPROVAL DRAWING REQUIRED
- ☐ CHANGE AS NOTED, REAPPROVAL REQUIRED  
MAKE CHANGES AS NOTED, SEND CORRECTED DRAWING FOR  
REAPPROVAL BEFORE MANUFACTURE

- CHANGES REQUEST:
1. \_\_\_\_\_
  2. \_\_\_\_\_
  3. \_\_\_\_\_
  4. \_\_\_\_\_
- SIGNATURE: \_\_\_\_\_ DATE: \_\_\_\_\_
- CAUTION: ONCE THE DRAWING IS APPROVED, JOB CANCELLATION FEES WILL APPLY

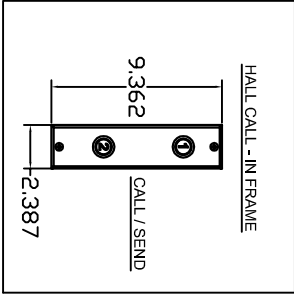
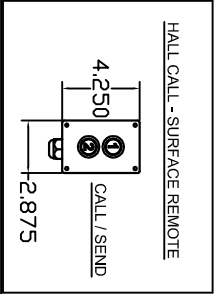
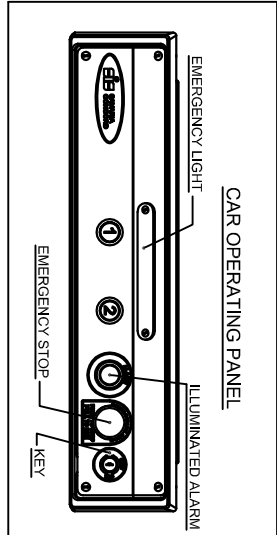

TOWER DETAIL

GENERAL ARRANGEMENT	
ENCLOSED VERTICAL WHEELCHAIR PLATFORM LIFT	
CUSTOMER: NATIONWIDE LIFTS - N.Y.	
PROJECT:	APEX COMPLETE - 42 WIDE X 60 DEEP
ADDRESS:	DOORS 90 DEGREES - TYPE 3
888-323-8755 INFO@ELEVATORS.COM	
DATE:	06/16/15
REVISION DATE:	06/18/15
COMPLETED BY:	AM/PA/RE/PL/TS
JOB No.	P0000001
SHEET No.	1 OF 4

OFFICE USE ONLY:	Port No.
CONFIGURATION VERSION STAMP: 0.0	Variant No. 48571
MODULE VERSION STAMP: B-5743	



PROVISIONS BY OTHERS

GENERAL

HOISTWAY – THE HOISTWAY MUST BE DESIGNED AND BUILT IN ACCORDANCE WITH ‘SAFETY STANDARD FOR PLATFORM LIFTS AND STAIRWAY CHAIRLIFTS’ OR ‘SAFETY CODE FOR ELEVATORS AND ESCALATORS’ AND ALL STATE AND LOCAL CODES.

PLUMB RUNWAY– DUE TO CLOSE RUNNING CLEARANCES OWNER/ AGENT MUST ENSURE THAT HOISTWAY AND PIT (WHERE PROVIDED) ARE LEVEL, PLUMB (-/+ 1/8” (3 mm)) AND SQUARE AND ARE IN ACCORDANCE WITH THE DIMENSIONS ON THESE DRAWINGS.

MINIMUM OVERHEAD CLEARANCE– OWNER/AGENT MUST ENSURE MINIMUM OVERHEAD CLEARANCE IS IN COMPLIANCE WITH CODES.

CONSTRUCTION SITE– OWNER/AGENT TO PROVIDE ALL MASONRY, CARPENTRY AND DRYWALL WORK AS REQUIRED AND SHALL PATCH AND MAKE GOOD (INCLUDING FINISH PAINTING) ALL AREAS WHERE WALLS/FLOORS MAY REQUIRE TO BE CUT, DRILLED OR ALTERED IN ANY WAY TO PERMIT THE PROPER INSTALLATION OF THE LIFT.

DIMENSIONS– CONTRACTOR/CUSTOMER TO VERIFY ALL DIMENSIONS AND REPORT ANY DISCREPANCIES TO OUR OFFICE IMMEDIATELY.

STRUCTURAL

FLOOR/SUPPORT WALL LOADS– CONTRACTOR TO ASSURE THAT BUILDING AND SHAFT WILL SAFELY SUPPORT ALL LOADS IMPOSED BY THE LIFT EQUIPMENT. REFER TO THE LOAD DIAGRAM ON THIS DRAWING.

MAST TO BE SECURELY FASTENED– WHERE REQUIRED THE MAST MUST BE SECURELY FASTENED TO THE STRUCTURAL SUPPORT WALL. REFER TO WALL / FLOOR SUPPORT LOAD DIAGRAM AND WALL LAG DIMENSIONS ON THIS DRAWING.

WHERE DOORS ARE REQUIRED– SUITABLE LINTELS MUST BE PROVIDED BY OWNER/AGENT. DOOR FRAMES ARE NOT DESIGNED TO SUPPORT OVERHEAD WALL LOADS.

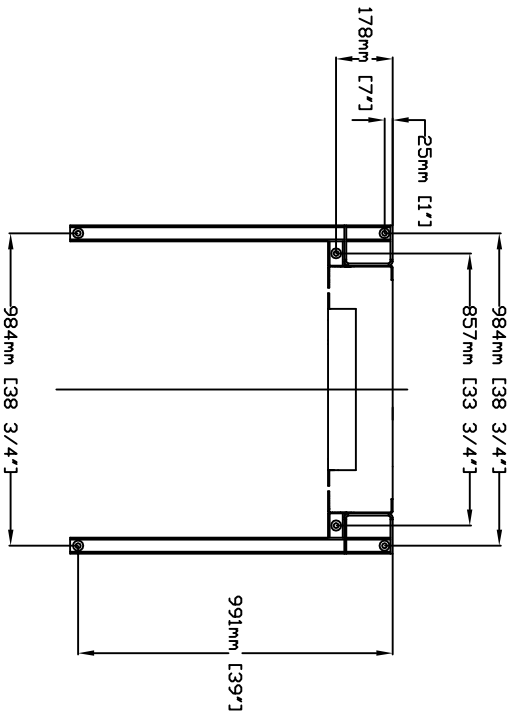

ELECTRICAL

GENERAL– ELECTRICAL EQUIPMENT AND WIRING TO COMPLY WITH SECTION 38 OF CSA C22.1 (CANADA) OR SECTION 620 OF NEC ANSI/NFPA 70 (USA).

POWER SUPPLY– 120VAC, 20A, 60HZ, 1PH CIRCUIT THROUGH A FUSE DISCONNECT WITH AUXILIARY CONTACT ON MAIN POWER SUPPLY. PROVIDE TWO 18 AWG CONDUCTORS BETWEEN CONTACT AND CONTROLLER.

LIGHTING–LIGHTING OF 100 LX MIN. AT PLATFORM AND LANDINGS. LIGHTING WITH SWITCH AND ELECTRICAL GFCI OUTLET IN HOISTWAY PIT.

ENTRANCES

UPPER LANDING GATES– WHERE REQUIRED, SMOOTH SOLID BARRIERS ARE TO BE SUPPLIED AND INSTALLED ON BOTH SIDES OF ENTRANCE AT UPPER LEVEL AND MUST BE A MINIMUM OF 42” (1067 mm) HIGH. ENTRANCE ASSEMBLY MUST BE IN PLACE PRIOR TO THIS PROVISION.

FASCIA PANEL BELOW UPPER LEVEL ENTRANCE– WHERE REQUIRED, FASCIA PANEL MUST BE FASTENED TO A SOLID WALL AND BE PERPENDICULAR TO THE FLOOR AND WALLS. HOISTWAY FASCIA IS NOT SELF-SUPPORTING FOR LONG, CONTINUOUS RUNS VOID OF ENTRANCES. ADEQUATE SUPPORT FOR THE FASCIA MUST BE PROVIDED.

ENTRANCE ASSEMBLIES– ENTRANCE ASSEMBLIES MUST BE ADJUSTED TO ALIGN WITH PLATFORM AND INTERLOCK EQUIPMENT. OTHERS TO ALLOW AN ADEQUATE ROUGH OPENING.

RETURN WALLS– RETURN WALLS AT ENTRANCES MUST BE BUILT-IN BY OTHERS AFTER ENTRANCE ASSEMBLIES ARE IN PLACE. ENTRANCE ASSEMBLY MUST BE SECURELY FASTENED TO WALLS.

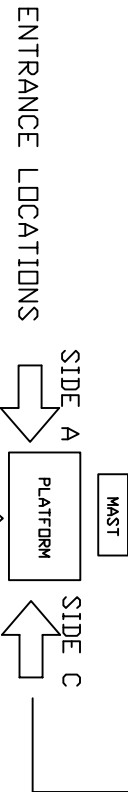
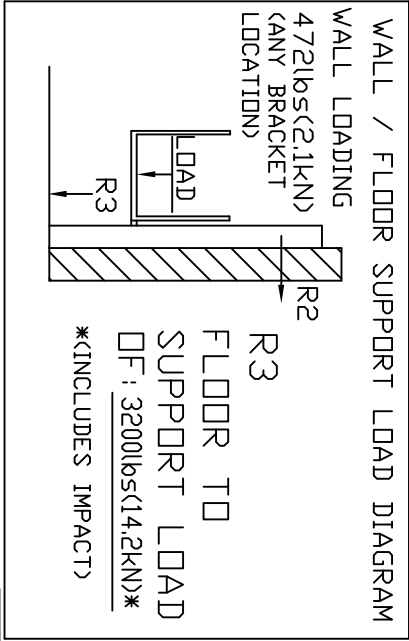

GENERAL

CLASSIFICATION:  
APPLIED CODE:  
SPECIAL NOTE:  
MODEL:  
CAPACITY:  
SPEED:  
TRAVEL:  
PIT DEPTH:  
PLATFORM SIZE:  
POWER SUPPLY:  
BATTERY BACK UP:

Enclosed Vertical Wheelchair Platform Lift  
ASME A18.1-2008 Section 2 Pub  
V-1504 Enclosure  
750 lbs (341 kg)  
20 fpm (0.102 m/s)  
120” (3048 mm)  
3” (76 mm)  
42” X 60” (1067 mm X 1524 mm)  
120V,20A,60Hz,SINGLE PHASE  
down direction only

JACK UNIT

STROKE:  
PLUNGER O/D:  
CYL. O/D:  
CYL. I/D:

CONTROLLER

MODEL:  
TYPE:  
ETL #:  
CONTROL VOLTS:  
CONTROL AMPS:  
H.P.:  
AMPS:  
MFR:

DOORS / GATES / CALL STATIONS

	LANDING 1	LANDING 2	LANDING 3	LANDING 4
DOOR TYPE	Enclosure 80" Door	Enclosure 80" Door		
DOOR SWING	C	b		
DOOR INSERT	rh	lh		
LOCK TYPE	Clear Plexiglass	Clear Plexiglass		
AUTO DOOR OPENER	WR500 Lock (24V)	WR500 Lock (24V)		
CUSTOM DOOR WIDTH	Commander Auto Opener	Commander Auto Opener		
CUSTOM DOOR HEIGHT				
IN FRAME CALL STN.	no	yes		
CALL STN. TYPE	Call/Send Buttons	Call/Send Buttons		
CALL STN. KEVED	Not Required	Not Required		
CALL STN. STOP BUTTON				
CALL STN. MOUNTING	Surface Mounted Remote	Flush Mounted In Frame		
ISOLATED PRODDOR KIT	No	No		

OPTIONS PROVIDED

WR500: Door Interlock Model STP3A-2131A024MC2318: Approval No.4745

EMERGENCY PENDENT PLUG IN MANUAL LOWERING BOX

WINGS:	no	RAMP:	No Ramp Required
TOUCH UP PAINT:	1 cans(s)	EXTRA KEYS:	0
BUILDING:	Public Building	WALL FASTENERS:	none
LIGHT CURTAIN:	no	UNDERPAN SENSOR:	no
PHONE OR PHONE PLUG:	No Phone,Plug Incl	COLOR:	Standard Color - Almond Beige

LOCATION: IN DOOR

POWER UNIT

MOTOR:  
FLOW:  
3.0 HP, 120 VAC  
1.15 Gal/min (4.35L/min)

HYDRAULIC DATA

OIL TYPE:  
GALLONS REQ'D:  
MAXIMUM WORKING PRESSURE:  
RELIEF PRESSURE:  
MAXIMUM RELIEF PRESSURE:  
HYDRAULIC HOSE:  
BURST:  
FITTINGS:  
UNIVIS 32 INDOOR  
DEXRON ATF OUTDOOR  
1.0 Gal (3.79 L)  
2000 psi (13.7 MPa)  
WPx125% MAX.  
2000 psi (13.7 MPa)  
1/4” (6.4 mm) ID  
20000 psi (137.9 MPa)  
1/4” (6.4 mm) NPT MALE

SUSPENSION CHAIN

2X #50 ROLLER CHAIN  
BREAKING STRENGTH:  
SAFETY BRAKE:  
7171 lbs (31.9 kN) each  
TYPE ‘A’

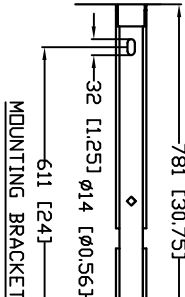

DATA SHEET

CUSTOMER: NATIONWIDE LIFTS - N.Y.  
PROJECT: APEX COMPLETE - 42 WIDE X 60 DEEP  
ADDRESS: DOORS 90 DEGREES - TYPE 3  
888-323-8755 INFO@ELEVATORS.COM

OFFICE USE ONLY:	DATE: 06/16/15	Variant No. 48571
CONFIGURATION VERSION STAMP: 0.0	REVISION DATE: 06/18/15	Port No.
MODULE VERSION STAMP: B57A13	COMPLETED BY: ANTONIO PERALTA	
JOB No. P0000002 OF 4		SHEET No. 4
savaria		22

# PANEL DRAWING

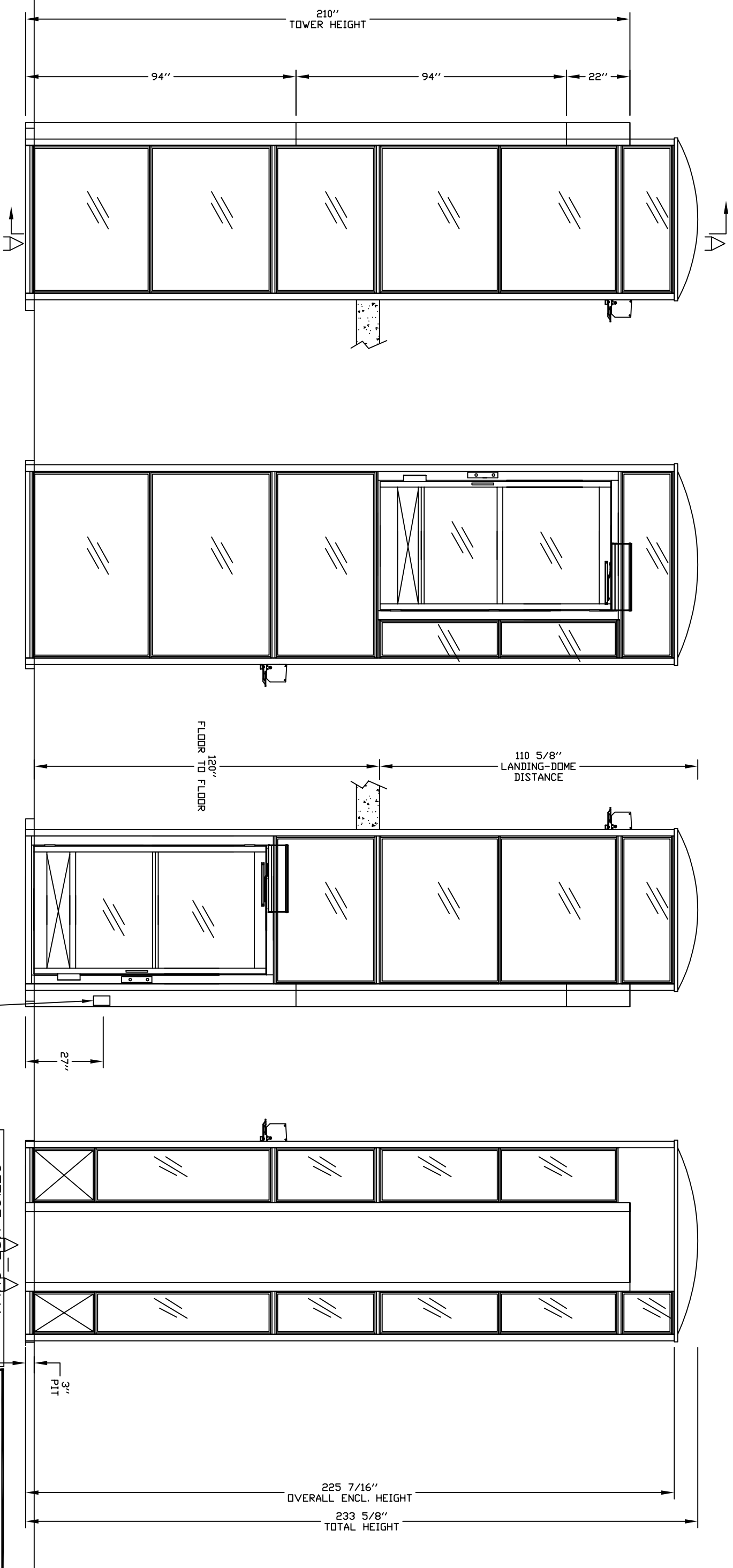

INSERT  
STYLE: Enclosure



SHEET METAL

Clear Plexigla

# ELEVATION VIEWS

ENCLOSED VERTICAL WHEELCHAIR PLATFORM LIFT

CUSTOMER:	DATE:
NA TIONWIDE LIFTS-N.Y.	06/16/15
PROJECT:	REASON DATE:
APEX COMPLETE - 42 WIDE X 60 DEEP	06/18/15
ADDRESS:	COMPLETED BY:
DORS 90 DEGREES - TYPE 3	ANDREW MALIN
888-323-8755	
INFO@ELEVATORS.COM	

OFFICE USE ONLY:	
DEVICE CONFIGURATION VERSION STAMP:	0.0
MODULE VERSION STAMP:	B-5.7A13

Part No.

Variant No. 48571



22

JOB No. P00000 SHEET No. 3 OF 4

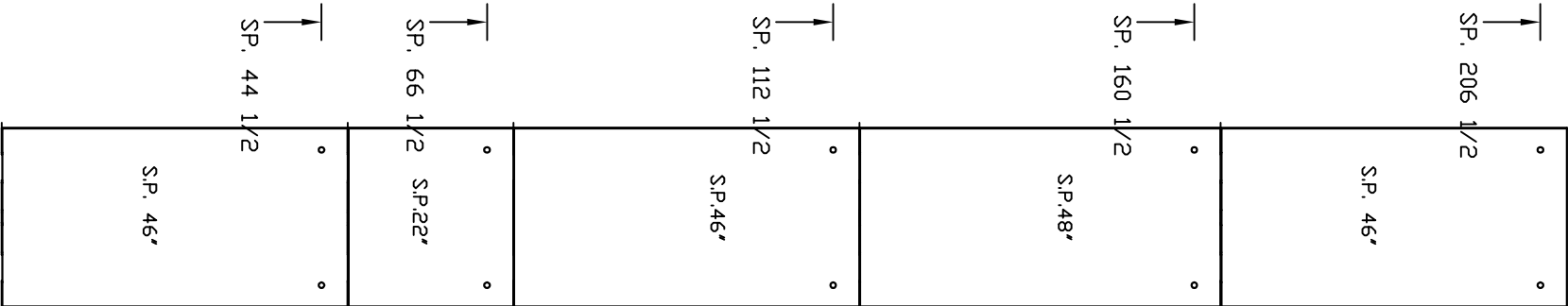
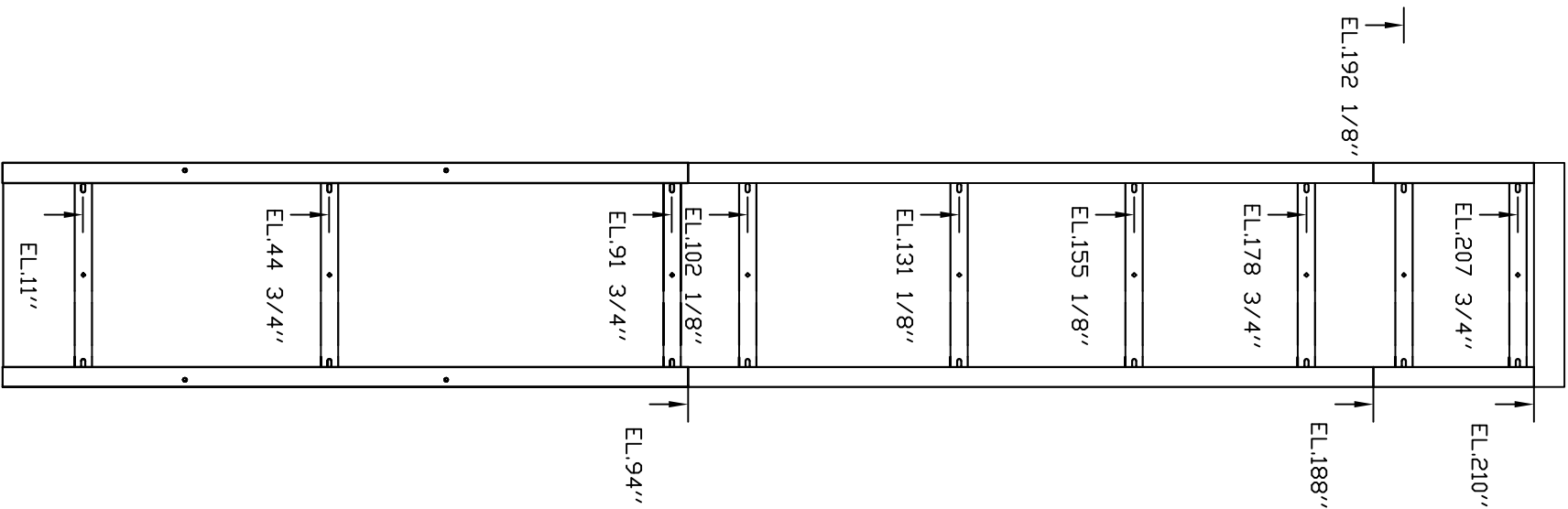
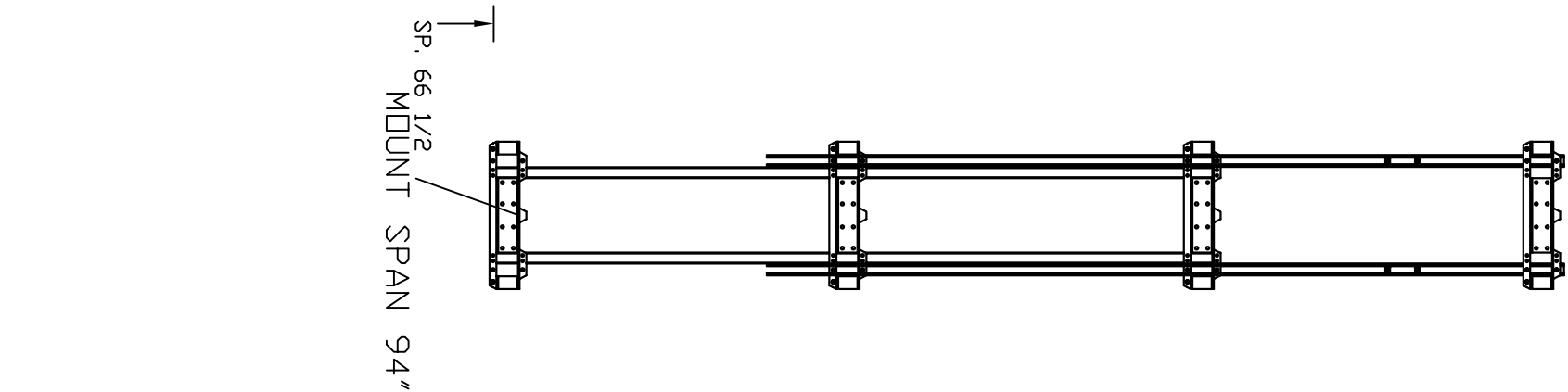

EL: MOUNTING BRACKET POSITION

OFFICE USE ONLY:	
CONFIGURATION VERSION STAMP:	0.0
MODULE VERSION STAMP:	B37A13

CUSTOMER: NATIONWIDE LIFTS - N.Y.

DATE: 06/16/15

PROJECT: APEX COMPLETE - 42 WIDE X 60 DEEP

REASON DATE: 06/18/15

ADDRESS: DOORS 90 DEGREES - TYPE 3

COMPLETED BY: 888-323-8755 INFO@ELEVATORS.COM

Part SERVICE PANEL

Variant No. 48571



JOB No. P000000

SHEET No. 4 OF 4

PLATFORM

WEIGHT (PLATFORM AND ACCESSORY): \_\_\_\_\_ BETWEEN 350 lbs TO 500 lbs

VERTICAL CLEARANCE OF THE ACCESS TO THE PLATFORM: \_\_\_\_\_ 6’-8” MIN

CAR GUIDE RAILS

RAIL SIZE: \_\_\_\_\_ 8LB/FT C CHANNEL

PLUNGER

TYPE OF STEEL: \_\_\_\_\_ AISI 1045

TENSILE STRENGTH: \_\_\_\_\_ 84,847 PSI

YIELD STRENGTH: \_\_\_\_\_ 74,694 PSI

MINIMUM PERCENTAGE ELONGATION IN 2” GAUGE LENGTH AS PER ASTM STANDARD E8: \_\_\_\_\_10%

WALL THICKNESS: \_\_\_\_\_ SOLID

HEAD THICKNESS: \_\_\_\_\_ SOLID

SHAPE OF HEAD: \_\_\_\_\_ FLAT

DISHED HEAD, DIMENSIONS (DRAWING REQUIRED): \_\_\_\_\_ N/A

CYLINDER

HEAD THICKNESS: \_\_\_\_\_ 0.35”

WALL THICKNESS: \_\_\_\_\_ 0.188”

SHAPE OF HEAD: \_\_\_\_\_ FLAT

DISHED HEAD, DIMENSIONS (DRAWING REQUIRED): \_\_\_\_\_ N/A

TYPE OF STEEL: \_\_\_\_\_ AISI 1026

TENSILE STRENGTH: \_\_\_\_\_ 71,000 PSI

YIELD STRENGTH: \_\_\_\_\_ 60,000 PSI

MINIMUM PERCENTAGE ELONGATION IN 2” GAUGE LENGTH AS PER ASTM STANDARD E8: \_\_\_\_\_20%

PIPING

NOMINAL DIAMETER: \_\_\_\_\_ N/A

SCHEDULE: \_\_\_\_\_ N/A